

| REVISION HISTORY | | | |
|------------------|--------------------|------------|----------|
| REV. | DESCRIPTION | DATE | APPROVED |
| A | REDRAWN w/o CHANGE | 05/11/2009 | KAH |

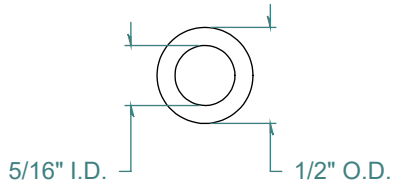
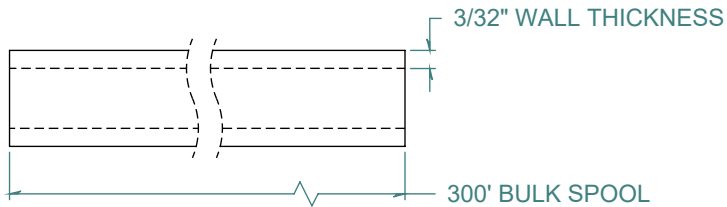
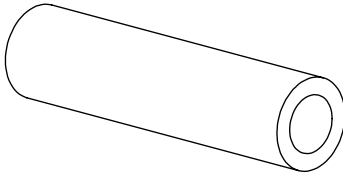

DIMENSIONS ARE IN INCHES UNLESS SPECIFIED. TOLERANCES ARE:

INNER DIAMETER +/- .005
 OUTER DIAMETER +/- .005
 WALL THICKNESS +/- .003

LENGTH TOLERANCES ARE:

120. OR MORE +5% / -0
 24.1 TO 120. +1.0 / -0
 12.1 TO 24.0 +.5 / -0
 6.1 TO 12.0 +.25 / -0
 .375 TO 6.0 +.125 / -0

ARK-PLAS PRODUCTS, INC.

TCX49-FA0
 5/16" I.D. x 1/2" O.D.
 3/32" WALL THICKNESS / 300' BULK SPOOL

NATURAL, CLEAR TUBING

MATERIAL: VINYL (PVC) - 68 DUROMETER

FREE SAMPLES ARE AVAILABLE FOR TESTING. CONTACT CUSTOMER SERVICE

PROPRIETARY AND CONFIDENTIAL

THE INFORMATION CONTAINED IN THIS DRAWING IS THE SOLE PROPERTY OF ARK-PLAS PRODUCTS, INC. ANY REPRODUCTION IN PART OR AS A WHOLE WITHOUT THE WRITTEN PERMISSION OF ARK-PLAS PRODUCTS, INC. IS PROHIBITED.

| | | | |
|------------------------------------|--------------|----------------------|------------------------|
| SIZE A | JOB # APT072 | DRAWN BY: <i>KAH</i> | REV. LEVEL A |
| SCALE: 1:1 DO NOT SCALE DRAWING | | SHEET 1 OF 1 | |