

Revision History

| Rev. | Description | Date | Approved |
|------|------------------|------------|----------|
| A | Redrawn w/Change | 02/15/2010 | KAH |
| B | ECOR #A0564 | 02/15/2010 | KAH |
| C | 1/4" ID Updated | 10/30/2023 | JWM |

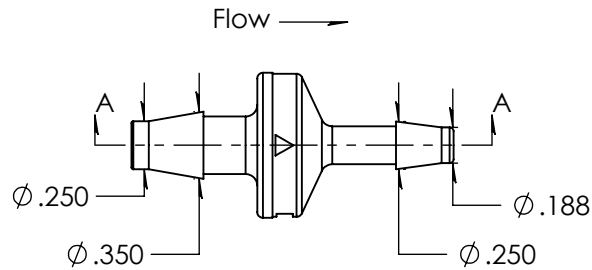
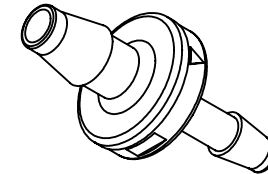
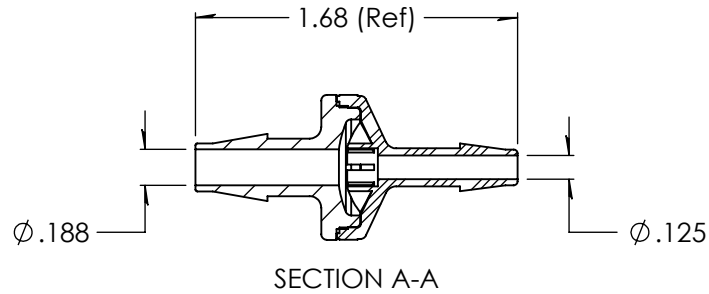

NOTE:
 Minimum crack pressure - .5psi
 Minimum seal pressure - 1.9psi

Unless otherwise specified tolerances are in inches

SAE Tolerances

| | |
|------------------|----------|
| Fractions: | +/- .015 |
| 2 Place Decimal: | +/- .010 |
| 3 Place Decimal: | +/- .005 |
| Angle: | +/- 1/2* |

Material:

Natural Polycarbonate 201-15
 Silicone Diaphragm / MED 9021 Lubrication

ARKPLAS

Part #: HCX86-YC0

Description:
 1/4" x 3/16" Reducing Check Valve

| | | | | |
|----------|------------|---------------|--------------|-----|
| A | Size | Job#: HCX86 | Sheet 1 of 1 | Rev |
| | Scale: 1:1 | Drawn By: JWM | C | |