

REVISION HISTORY			
REV.	DESCRIPTION	DATE	APPROVED
A	REDRAWN w/o CHANGE	07/23/2009	KAH

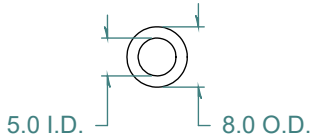
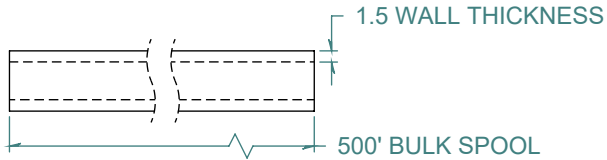
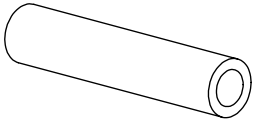

DIMENSIONS ARE IN METRIC UNLESS SPECIFIED. TOLERANCES ARE:

INNER DIAMETER +/- .127
 OUTER DIAMETER +/- .127
 WALL THICKNESS +/- .076

LENGTH TOLERANCES ARE:

3048. OR MORE	+5% / -0
612.14 TO 3048.	+25.4 / -0
307.34 TO 609.6	+12.7 / -0
154.94 TO 304.8	+6.35 / -0
9.525 TO 152.4	+3.175 / -0

ARK-PLAS PRODUCTS, INC.

TCX73-FA0
 5.0 I.D. x 8.0 O.D.
 1.5 WALL THICKNESS / 500' BULK SPOOL

NATURAL, CLEAR METRIC TUBING

MATERIAL: VINYL (PVC) - 68 DUROMETER			
SIZE	JOB # APT080	DRAWN BY: <i>KAH</i>	REV. LEVEL
A	SCALE: 1:1 DO NOT SCALE DRAWING	SHEET 1 OF 1	A

FREE SAMPLES ARE AVAILABLE FOR TESTING. CONTACT CUSTOMER SERVICE

PROPRIETARY AND CONFIDENTIAL

THE INFORMATION CONTAINED IN THIS DRAWING IS THE SOLE PROPERTY OF ARK-PLAS PRODUCTS, INC. ANY REPRODUCTION IN PART OR AS A WHOLE WITHOUT THE WRITTEN PERMISSION OF ARK-PLAS PRODUCTS, INC. IS PROHIBITED.