

REVISION HISTORY			
REV.	DESCRIPTION	DATE	APPROVED
A	PRINT RELEASE DATE	01/27/2011	KAH

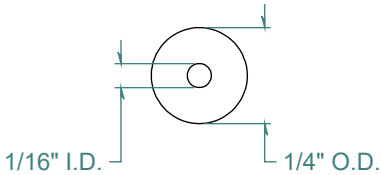
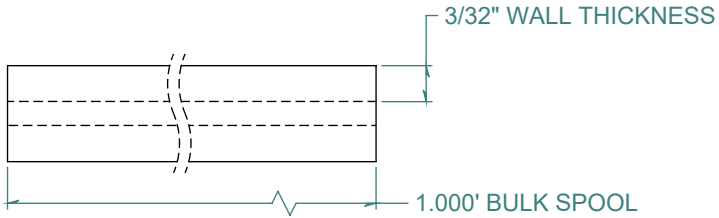
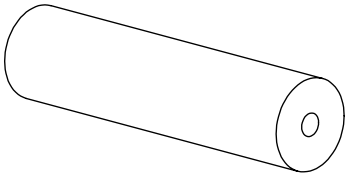

DIMENSIONS ARE IN INCHES UNLESS SPECIFIED. TOLERANCES ARE:

INNER DIAMETER	+/- .005
OUTER DIAMETER	+/- .005
WALL THICKNESS	+/- .003

LENGTH TOLERANCES ARE:

120. OR MORE	+5% / -0
24.1 TO 120.	+1.0 / -0
12.1 TO 24.0	+ .5 / -0
6.1 TO 12.0	+ .25 / -0
.375 TO 6.0	+ .125 / -0

**ARK-PLAS PRODUCTS, INC.**

TCX35-FR0  
 1/16" I.D. x 1/4" O.D.  
 3/32" WALL THICKNESS / 1,000' BULK SPOOL

NATURAL, CLEAR TUBING

FREE SAMPLES ARE AVAILABLE FOR TESTING. CONTACT CUSTOMER SERVICE

MATERIAL: VINYL - PHTHALATE FREE (PVC)  
 70 DUROMETER

**PROPRIETARY AND CONFIDENTIAL**

THE INFORMATION CONTAINED IN THIS DRAWING IS THE SOLE PROPERTY OF ARK-PLAS PRODUCTS, INC. ANY REPRODUCTION IN PART OR AS A WHOLE WITHOUT THE WRITTEN PERMISSION OF ARK-PLAS PRODUCTS, INC. IS PROHIBITED.

SIZE	JOB # APT227	DRAWN BY: <i>KAH</i>	REV. LEVEL
<b>A</b>	SCALE: 2:1 DO NOT SCALE DRAWING	SHEET 1 OF 1	<b>A</b>