

REVISION HISTORY			
REV.	DESCRIPTION	DATE	APPROVED
A	REDRAWN w/ CHANGE	10/12/2009	KAH
B	ECOR #A0144	10/12/2009	KAH
C	ECOR #A0751	04/27/2012	KAH

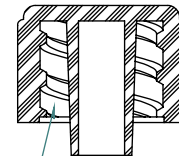
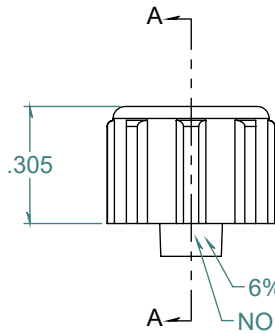
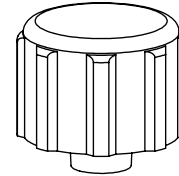
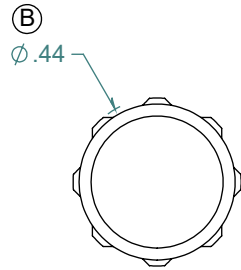

SECTION A-A  
SCALE 2 : 1

6% TAPERED SLIP MALE      5 TPI DOUBLE LEAD RIGHT HAND THREAD  
NO PARTING LINE ALLOWED ON THIS SURFACE

DIMENSIONS ARE IN INCHES UNLESS SPECIFIED. TOLERANCES ARE:  
 FRACTIONS                    +/- .015  
 2 PLACE DECIMAL           +/- .010  
 3 PLACE DECIMAL           +/- .005  
 ANGLES                         NOTED

**ARK-PLAS PRODUCTS, INC.**

LPA31-YC0  
LOCKING MALE LUER PLUG

FREE SAMPLES ARE AVAILABLE FOR TESTING. CONTACT CUSTOMER SERVICE

MATERIAL:  
POLYCARBONATE, NATURAL

LUER DESIGNED TO **ISO** STANDARD

**PROPRIETARY AND CONFIDENTIAL**  
 THE INFORMATION CONTAINED IN THIS DRAWING IS THE SOLE PROPERTY OF ARK-PLAS PRODUCTS, INC. ANY REPRODUCTION IN PART OR AS A WHOLE WITHOUT THE WRITTEN PERMISSION OF ARK-PLAS PRODUCTS, INC. IS PROHIBITED.

FINISH:  
RMS 109.2

SIZE <b>A</b>	JOB # MP277	DRAWN BY: <i>KAH</i>	REV. LEVEL
	SCALE: 2:1 DO NOT SCALE DRAWING	SHEET 1 OF 1	<b>C</b>