

Revision History

Rev.	Description	Date	Approved
A	Redrawn w/Change	04/07/2010	KAH
B	ECOR #A0144	04/07/2010	KAH
C	ECOR #A0598	04/07/2010	KAH
D	ECOR #A0896	10/02/2015	KAH
E	ECO #A1175	08/13/2019	KAH
F	Callouts Updated	01/24/2024	JWM

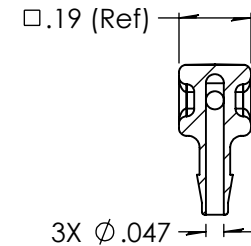

SECTION A-A
SCALE 2 : 1

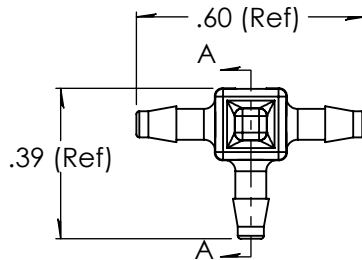
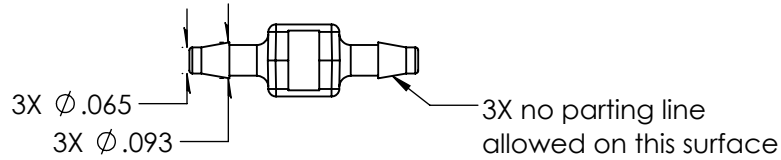
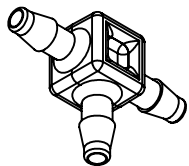

Unless otherwise specified tolerances are in inches

SAE Tolerances

Fractions:	+/- .015
2 Place Decimal:	+/- .010
3 Place Decimal:	+/- .005
Angle:	+/- 1/2*

Material:
White Nylon
101FNC010

ARKPLAS

Part #: MFA66-NY2

Description:
1/16" x 1/16" x 1/16" Premium Grade Barbed Tee Connector

Size	Job#:	Sheet	Rev
A	MFA66	1 of 1	F
	Scale: 2:1	Drawn By: JWM	